

小型粉碎機 Sample Mill



* 標準配備：主機+標準型粉碎杯+標準蓋 * Standard equipment : Machine body+Standard container+Standard lid

Model	SM-3	SM-3C (cool type)	SM-3L
馬力 Motor	700 W (Max : 1200 W)		
轉速 Speed (rpm)	0 ~ 28,000 rpm (At no sample-load)		
粉碎杯內尺寸 Container Size (Inner)	Ø108 x 51mm		Ø132 x 57mm
最大容量 Max. Cap.	150ml		200ml
外觀尺寸 Overall Size (mm)	Ø170 x 330	Ø182 x 330	Ø170 x 335
重量 Weight (Kg)	5.1	6	5.6
電源 Power	AC 110V / 220V, 50 / 60Hz		

特點：

- 緩衝式啟動、過載保護、過熱保護、運轉中粉碎杯分離主體，馬達立即斷電。
- 粉碎杯為分離式，可取下來清理試料。
(可加購粉碎杯互換)。
- 適用乾燥後之食品、藥品、礬土、骨、種子、穀物、瓷器、礦物等等。
- 冷卻型粉碎機夾層設計，以循環方式來降低粉碎杯溫度。
- 微量蓋可在極短時間內將試料粉碎到更為細小。
(微量蓋為選購品)

Feature :

- With a buffer device, current overloading & motor overheating protection-devices, and an immediate power-cutoff device acting when the container is separated from the machine
- The container unit and machine body are separated; users can take off the container unit for dry cleaning after use (Users also can purchase a few container units for alternate using)
- Useful to crush dried food、drugs、alumina、bones、grains and seeds, porcelain and minerals, etc
- Cooling-type mill is based on cooling the temperature by a circulation through the cavity wall to reduce the temperature inside the container
- Using Extra lid can work out samples to be finer powder within a shorter period
(Extra lid is an optional accessory)

小型粉碎機 Sample Mill



標準蓋
Standard lid



大容量蓋
Large cap. lid



微量蓋 (選購品)
Extra lid
(Optional purchase)



透明蓋 (選購品)
Transparent lid
(Optional purchase)



標準型粉碎杯(150ml)
Standard container



冷卻型粉碎杯(150ml)
Cool type container



大容量粉碎杯(200ml)
Large cap. container

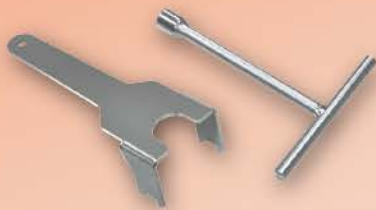

刀片拆裝工具組 (選購品)
Blade dismantling tool set
(Optional purchase)



杯座拆裝工具組 (選購品)
container dismantling tool set
(Optional purchase)



紅麴



山藥



香附

粉碎前

Before
grinding



粉碎後

After
grinding